

Satisfy Professional's Needs



Auto Feed Screwdriver

6842 / 6843 / 6844 / 6845

Quick Shot!



More Reliable Casing Attach



Adjustable Stopper Base with 7 settings for different screw lengths

Indicator line for feeding position

Sturdy aluminum
Stopper base with anti-tilt device for preventing sway
Rubber cap securely adheres to the stopper base
Dust-proof construction for smooth operation

Quick Shooting

with Silent Clutch

New Silent Clutch Features high durability. Ensures high operation efficiency with direct drive transmission in reverse rotation.

Less noise at the end of driving process

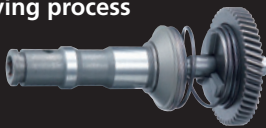

The utmost durable clutch

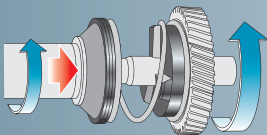

When the bit pushes screw, synchronized rotation starts for smooth engagement.

The clutch is durable even against 6000rpm speed (model 6843).



Anti-tilt device for sure positioning and preventing swaying

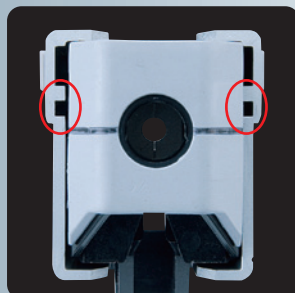

Guide rail Provided for smooth sliding.



Ergonomically Designed Rubberized Grip Provides more control and comfort.

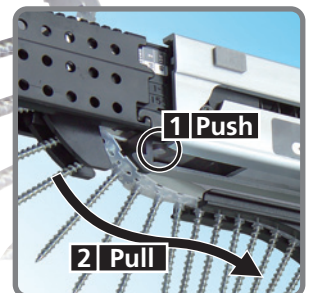

Screw strip also can be removed in the direction of the arrow by pushing button.



1 Reverse Operation
2 Lock for Control

ment

exc. 6845

Minimum casing
 screws from swaying
 rered to stopper base
 smooth sliding action

Casing can be removed/installed without tool.



Hook
 attachable
 to both sides

Externally Accessible
 Carbon Brush



Reverse Switch
 Operable by One Hand
 On-Button
 Continuous Operation



Screw Guide
 // Designed to prevent collated screw strip from getting tangled
 // Foldable for easy transport and storage



6842

4,700rpm

Capacity:
 4mm X 25mm to 55mm
 (5/32" X 1" to 2-3/16")

6843

6,000rpm

Capacity:
 4mm X 25mm to 55mm
 (5/32" X 1" to 2-3/16")

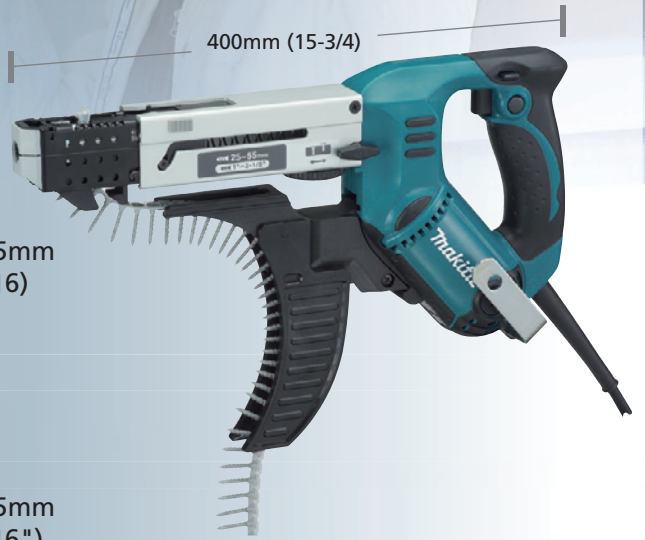

400mm (15-3/4)

6844

3,000rpm

Capacity:
 4mm X **45mm to 75mm**
 (5/32" X 1-3/4" to 2-15/16")

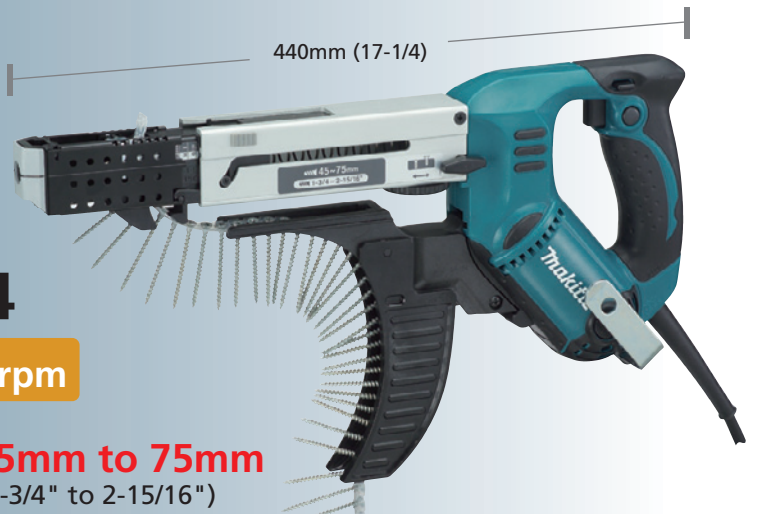

440mm (17-1/4)

Compact and Lightweight Design for High Maneuverability

Coil Magazine
 holds up
 to 100 screws.

6845

4,700rpm

Capacity:
 4mm X 25mm to 41mm
 (5/32" X 1 to 1-5/8")



333mm (13-1/8)

Lightweight
1.9kg (4.2lbs)



Accessories

Extension handle
Part No. 194500-1



Phillips bit 5pc per pkg.



For Model	Size	Length (mm)	Part No.
6842, 6843	No.2	162	B-10481
6844	No.2	182	B-10475
6845	No.2	122	A-45858



Comparison of Efficiency

Note: 1. It may differ under some conditions.

2. Numbers in the charts below are relative values when the capacities of Makita Model 6834 are indexed at 100.

1

Test conditions:

Drove 35mm drywall screws through a plasterboard into Douglas-fir timber.

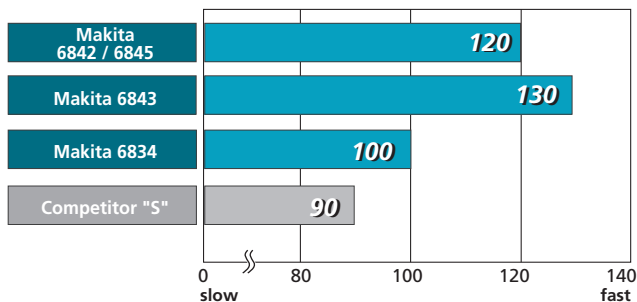

2

Test conditions:

Drove 55mm drywall screws through three plasterboard into Douglas-fir timber.

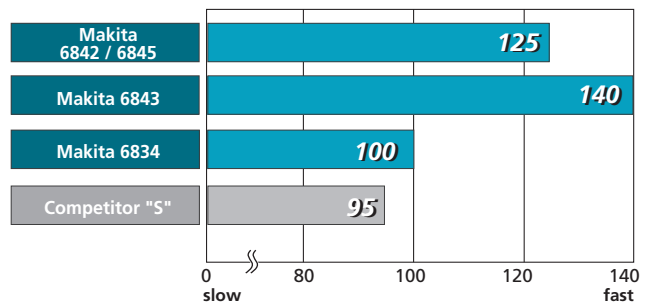

Auto Feed Screwdriver 6842 / 6843 / 6844 / 6845

411

- Double Insulation
- Reversing
- Carrying Case

	6842	6843	6844	6845
Continuous rating Input	470W	470W	470W	470W
Capacity Drywall screw:	4 x 25-55mm	4 x 25-55mm	4 x 45-75mm	4 x 25-41mm
	(5/32"x 1"-2-3/16")	(5/32"x 1"-2-3/16")	(5/23"x1-3/4"-2-15/16")	(5/32"x 1"-1-5/8")
Bit size Hex Shank :	6.35mm (1/4")	6.35mm (1/4")	6.35mm (1/4")	6.35mm (1/4")
No load speed	4,700rpm	6,000rpm	3,000rpm	4,700rpm
Dimensions (L x W x H)	400 x 75 x 243mm	400 x 75 x 243mm	440 x 75 x 243mm	333 x 83 x 247mm
	(15-3/4" x 2-15/16" x 9-9/16")	(15-3/4" x 2-15/16" x 9-9/16")	(17-1/4" x 2-15/16" x 9-9/16")	(13-1/8" x 3-1/4" x 9-3/4")
Net weight	2.0kg (4.4lbs)	2.0kg (4.4lbs)	2.1kg (4.6lbs)	1.9kg (4.2lbs)
Power supply cord	2.5m (8.2ft)	2.5m (8.2ft)	2.5m (8.2ft)	2.5m (8.2ft)

Standard Equipment
Phillips Bit (3pcs.)

Items of standard equipment and specifications may differ by country or area.

Makita Corporation

3-11-8 Sumiyoshi-cho, Anjo, Aichi, 446-8502 Japan

PRINTED IN JAPAN Z15215-2 2007-07