



Satisfy Professional's Needs

Power Scraper  
HK1820 / HK1820L

# SDS-Plus Scrapers

HK1820L  
Long handle type

HK1820  
Standard type



# SDS-Plus Power Scraper



## Standard type

**HK1820**



**Lock-On Button** (HK1820 only)  
Easy-to-operate for both right and left handed users

### Vibration Absorbing Handle

(HK1820 only)  
Spring absorbs vibration

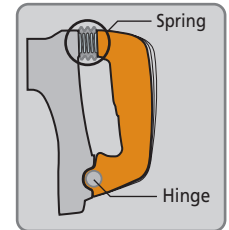

**Ergonomically Designed Rubberized Grip**

Lightweight  
**3.3kg**  
(7.3lbs)

**Barrel Cover**  
Allows for comfortable barrel gripping.

### Comparison of Vibration level\* and Time to reach ELV (Exposure Limit of Vibration)\*\*

	50min	100min	Time to reach ELV
Makita HK1820	10m/s <sup>2</sup>		120min
Makita HK1810	13.5m/s <sup>2</sup>		66min
Competitor "H"	15m/s <sup>2</sup>		53min
Competitor "B"	16.5m/s <sup>2</sup>		44min

Vibration level: 10m/s<sup>2</sup> 15m/s<sup>2</sup> 20m/s<sup>2</sup> 25m/s<sup>2</sup>

\*It is known as the tri-axial value and value at Directive of A(8).  
\*\*It means the maximum amount of vibration that an operator may be exposed to on any single day.



**One-Touch Sliding Chuck**  
for easy bit changes

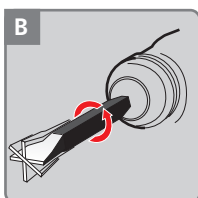

**Chisel Rotates**  
full 360 degrees with 12 different locking positions.

**Variable Speed Control by Dial** (HK1820 only)  
Enables to adjust scraping power to the material of subfloor/ subwall.

**Large Trigger Switch** (HK1820 only)  
with variable speed control function

1,293mm (51")

## Long handle type

**HK1820L**



**Long handle**  
enables to remove flooring materials without bending your back.



Tool does not come with Scraper assembly.

### Comparison of Chipping Efficiency

Note: 1. It may differ under some conditions.  
2. Numbers in the charts below are relative values when the capacities of Makita HK1820 are indexed at 100.

**Test conditions:** Chipped concrete, and measured the amount of concrete removed.

**Test material:** Concrete with compressive strength of 40N/mm<sup>2</sup>

Makita HK1820	100
Competitor "H"	100
Competitor "H"	60

0 small 50 100 large

### Power Scraper

- Double Insulation
- Variable Speed (HK1820)
- SDS-Plus Shank
- Carrying Case (HK1820)



### HK1820 / HK1820L SDS-Plus Shank

350mm

	HK1820	HK1820L
Continuous rating Input	550W	510W
Impacts per minute (ipm)	0-3,200	3,100
Dimensions (L x W x H)	351x 102 x 203mm (13-3/4" x 4" x 8")	1,293x 116 x 386mm (51" x 4-9/16" x 15-1/4")
Net weight	3.3kg (7.3lbs)	5.2kg (11.5lbs)
Power supply cord	5.0m (16.4ft)	5.0m (16.4ft)

#### Standard Equipment

HK1820: Bull Point, Scaling Chisel, Scaling Chisel (for tile), Hook Complete  
HK1820L: Hex Wrench (Tool does not come with Scraper assembly.)

Items of standard equipment and specifications may differ by country or area.

## Makita Corporation

3-11-8 Sumiyoshi-cho, Anjo, Aichi, 446-8502 Japan

PRINTED IN JAPAN Z23353-2 AI-AF