



Recipro Saw
JR3050T

Powerful 9.0A motor increase cutting efficiency



Well balanced Tool design for better handling



Performance Data

• Comparison of cutting speed

Test conditions: Cut a piece of 2"x10" spruce timber and a 1" carbon steel pipe for plumbing with each supplied saw blade (for wood or for metal), and measured the time required.

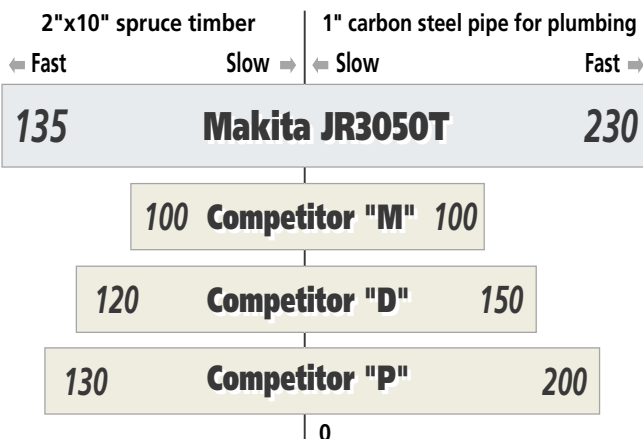

For Wood: Used Makita Blade No.23.

For Metal: Used the standard Blade of each Blade.

- The numbers in the charts above are relative values when the capacity of Competitor "M" is indexed at 100.
- The test results may differ under some conditions.

Tool-less Blade Change

Push-in Lock System has made it possible to attach the blade quickly.

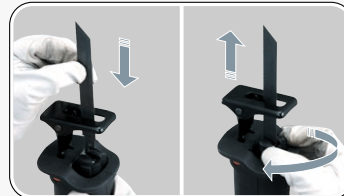

Tool-less shoe Adjustment

Push the red button for adjusting shoe position.



Dustproof and Dripproof Design

1. Front side of the slider is protected against saw-dust by;
 - 1) Air from the fan that sweeps saw-dust
 - 2) X ring and Felt that seal out saw-dust from the gear room
2. Gear room is also protected against water drops by a rubber seal ring.

Soft Grip



Large Trigger Switch



SPECIFICATIONS

| | |
|----------------------------------|--|
| Continuous rating Input Capacity | 1,010W in pipe : 90 mm (3-1/2") in wood : 90 mm (3-1/2") |
| Length of stroke | 28 mm (1-1/8") |
| Strokes per min. | 0-2,800 |
| Overall length | 452 mm (17-3/4") |
| Net weight | 3.2 kg (7.1 lbs) |
| Power supply cord | 2.5 m (8.2 ft.) |



Specifications may differ from country to country.

STANDARD EQUIPMENT

Recipro Saw Blade Set (No.21, 22, 23 : 1 each)

Items of standard equipment may differ from country to country.

OPTIONAL ACCESSORIES

Please see. General Catalogue.